

SOUTH SHORE RIVERFRONT PARK

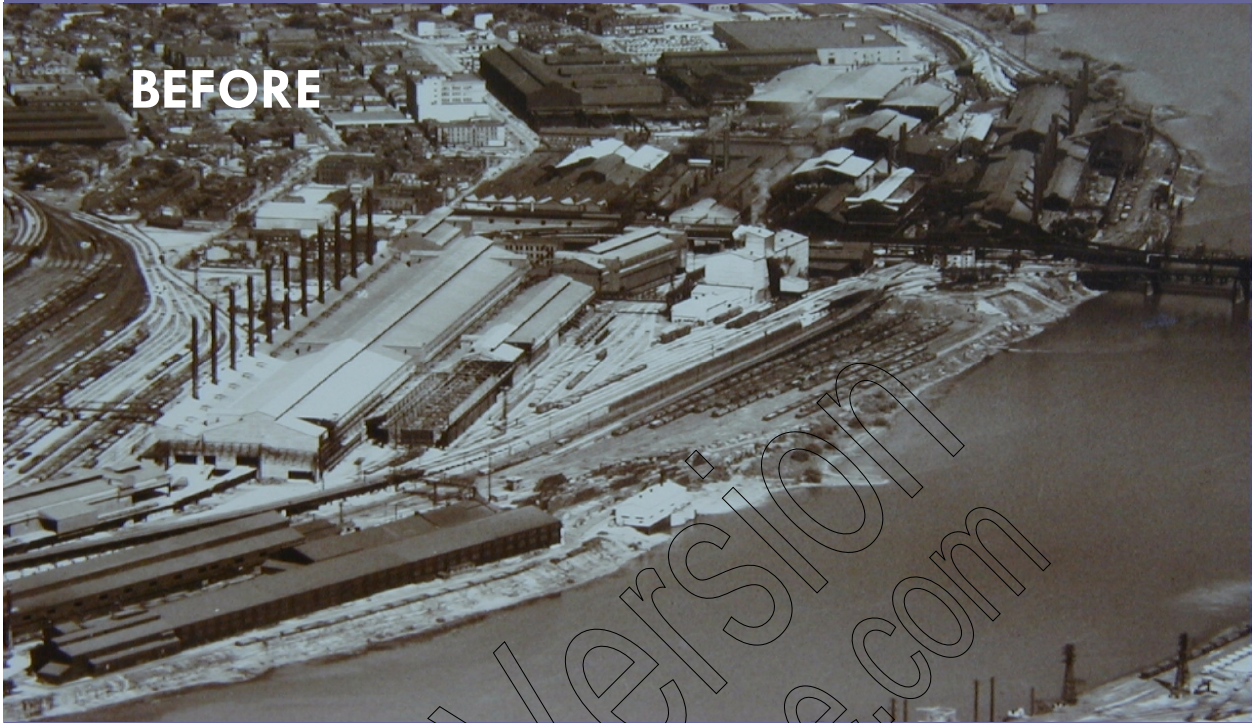

BEFORE

Address: Monongahela River between 25th & 29th streets

Neighborhood: South Side

Council District: 3

Project Type: Public Space

Total Public Subsidy: \$10,500,000

Total Cost: \$10,500,000

AFTER

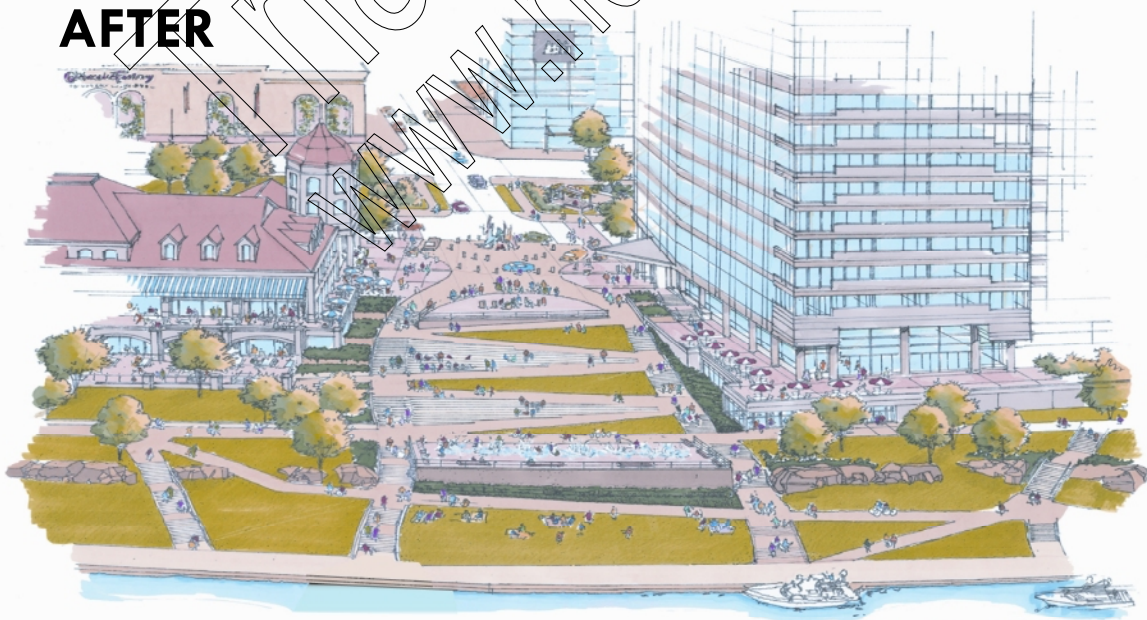

**ILLUSTRATIVE PERSPECTIVE
SOUTH SHORE RIVERFRONT PARK**

Prepared for: South Side Local Development Company
Prepared by: Environmental Planning and Design, Inc.

Date: July 31, 2006
2007.06.15

BUILDING PITTSBURGH WITH

URA
URBAN REDEVELOPMENT
AUTHORITY OF PITTSBURGH

SOUTH SHORE RIVERFRONT PARK

Project Brief

The South Shore Riverfront Park project is located at SouthSide Works between 25th and 29th Streets along the Monongahela River, a 34-acre development on the former Jones & Laughlin steel mill site.

The park has an estimated price tag of \$10.5 million, and will include a hotel, restaurant, residential buildings, trails, a boating tie-up facility, water access, interpretive signage and historic trail markers, continuing the Three Rivers Heritage Trail system and Great Allegheny Passage.

At completion, the park will become a multi-modal hub, connecting to the Hot Metal Pedestrian Bridge and bike trail, and will allow for the future expansion of waterfront activities. The South Shore Riverfront Park differs from other Pittsburgh waterfront parks with an amphitheatre, trail access, and proximity to the SouthSide Works retail complex.

The park development is an example of a successful public – private partnership that has enabled dramatic transformation.

Delivery: 2012

Project Status: Under Construction

Developer: Soffer Organization

Architect: Environmental Planning and Design

Contractor: Various

Partners: South Side Local Development Company, Riverlife Task Force, and City of Pittsburgh Department of Planning, Rivers of Steel National Heritage Area

Funding Sources:

Urban Redevelopment Authority of Pittsburgh

Heinz Endowments

R.K. Mellon Foundation

U.S. Fish and Wildlife Service

Department of Conservation and Natural Resources (DCNR)

NiSource

Soffer Organization

PennDOT

U.S. Congressman Mike Doyle

U.S. Senators Bob Casey and Arlen Specter

PA State Senator Jay Costa

State Representative Jake Wheatley